



d ₁	Δ	KS							D A T A	
			d ₃	d ₄	s		n min.	h ≈	 (kg/1000)	H (N)
1.5	+0.000 -0.025	KS1.5	1.30	6.00	0.25	3	2.5	1.2	0.10	200
2.0		KS2.0	1.80	7.00	0.30	3	2.5	1.3	0.13	400
2.5		KS2.5	2.30	8.25	0.30	3	2.5	1.5	0.15	700
3.0		KS3.0	2.80	10.00	0.40	3	3.0	2.0	0.20	1200
3.5	+0.000 -0.030	KS3.5	3.25	11.50	0.40	3	3.0	2.0	0.25	1200
4.0		KS4.0	3.75	13.00	0.50	4	3.5	2.4	0.50	1300
5.0		KS5.0	4.75	15.00	0.50	4	3.5	2.7	0.75	1500
6.0		KS6.0	5.75	16.50	0.60	6	4.0	2.6	1.15	1800
7.0	+0.000 -0.036	KS7.0	6.75	18.00	0.60	6	4.0	2.9	1.25	2000
8.0		KS8.0	7.75	19.50	0.70	6	4.0	2.8	1.40	3000
9.0		KS9.0	8.75	21.00	0.70	6	4.0	3.0	1.50	3500
10.0		KS10.0	9.75	22.00	0.80	6	4.0	3.0	1.65	4000

 **Part Number**
Référéncie Teile Nummer Referencia de pieza

 **Tolerance**
Tolérance Toleranz Tolerancia

 **Weight**
Masse Gewicht Peso

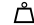
 **Ring**
Anneau/Circlips Ring Anillo

 **Groove**
Gorge Nut Ranura

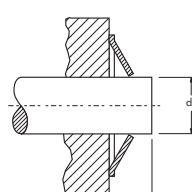
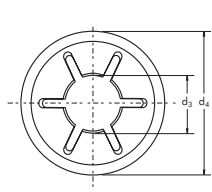

KS

CIRTEQ