

Rondelles d'ajustage Paßscheiben/DIN 988PS Arandelas de ajuste SHIM WASHERS

∅		DIN988 PS	>■< / ∅												kg/1000								
d	D		0.1	-0.03	0.15	-0.04	0.2	-0.04	0.25	-0.04	0.3	-0.05	0.5	-0.05	1.0	-0.05	1.2	-0.07	1.5	-0.07	2.0	-0.07	
3	6	PS3 X 6 X >■<	0.016		0.024		0.032		0.040		0.050		0.083		0.165								
4	8	PS4 X 8 X >■<	0.030		0.045		0.060		0.075		0.089		0.148		0.296								
5	10	PS5 X 10 X >■<	0.046		0.069		0.092		0.115		0.139		0.231		0.462								
6	12	PS6 X 12 X >■<	0.067		0.101		0.134		0.168		0.200		0.333		0.666								
7	13	PS7 X 13 X >■<	0.074		0.111		0.148		0.185		0.221		0.369		0.738								
8	14	PS8 X 14 X >■<	0.082		0.123		0.164		0.205		0.245		0.408		0.815								
9	15	PS9 X 15 X >■<	0.089		0.134		0.178		0.223		0.270		0.445		0.891								
10	16	PS10 X 16 X >■<	0.096		0.144		0.192		0.240		0.290		0.481		0.963								
11	17	PS11 X 17 X >■<	0.103		0.155		0.206		0.258		0.310		0.515		1.030								
12	18	PS12 X 18 X >■<	0.111		0.167		0.222		0.278		0.332		0.555		1.110								
13	19	PS13 X 19 X >■<	0.119		0.179		0.237		0.296		0.357		0.595		1.190		1.428						
14	20	PS14 X 20 X >■<	0.126		0.189		0.252		0.315		0.378		0.630		1.260		1.512						
15	21	PS15 X 21 X >■<	0.133		0.199		0.266		0.333		0.399		0.665		1.330		1.596						
15	22	PS15 X 22 X >■<	0.137		0.205		0.274		0.342		0.410		0.683		1.360		1.636						
16	22	PS16 X 22 X >■<	0.140		0.210		0.280		0.350		0.420		0.700		1.400		1.680						
17	24	PS17 X 24 X >■<	0.177		0.266		0.354		0.443		0.530		0.885		1.770		2.124						
18	25	PS18 X 25 X >■<	0.185		0.278		0.370		0.463		0.551		0.925		1.850		2.220						
19	26	PS19 X 26 X >■<	0.194		0.291		0.388		0.485		0.584		0.970		1.940		2.328						
20	28	PS20 X 28 X >■<	0.236		0.354		0.472		0.590		0.710		1.180		2.360		2.832		3.540				
22	30	PS22 X 30 X >■<	0.257		0.386		0.514		0.643		0.770		1.280		2.570		3.084		3.855				
22	32	PS22 X 32 X >■<	0.333		0.500		0.666		0.833		1.000		1.660		3.330		3.996		4.995				
25	35	PS25 X 35 X >■<	0.370		0.555		0.740		0.925		1.110		1.850		3.700		4.440		5.550				
25	36	PS25 X 36 X >■<	0.414		0.621		0.828		1.035		1.240		2.070		4.140		4.968		6.210				
26	37	PS26 X 37 X >■<	0.427		0.641		0.854		1.068		1.280		2.130		4.270		5.124		6.400				
28	40	PS28 X 40 X >■<	0.503		0.755		1.006		1.258		1.510		2.510		5.030		6.036		7.540				
30	42	PS30 X 42 X >■<	0.535		0.803		1.070		1.338		1.600		2.680		5.350		6.420		8.030		10.7		
32	45	PS32 X 45 X >■<	0.619		0.929		1.238		1.548		1.860		3.100		6.190		7.430		9.290		12.4		
35	45	PS35 X 45 X >■<	0.495		0.743		0.990		1.238		1.490		2.480		4.950		5.940		7.430		9.9		
36	45	PS36 X 45 X >■<	0.451		0.677		0.902		1.128		1.350		2.250		4.510		5.410		6.760		9.0		
37	47	PS37 X 47 X >■<	0.516		0.774		1.032		1.290		1.550		2.580		5.160		6.190		7.740		10.3		
40	50	PS40 X 50 X >■<	0.554		0.831		1.108		1.385		1.690		2.770		5.540		6.650		8.310		11.1		
42	52	PS42 X 52 X >■<	0.580		0.870		1.060		1.350		1.730		2.900		5.780		6.930		8.680		11.5		
45	55	PS45 X 55 X >■<	0.620		0.930		1.220		1.530		1.850		3.100		6.200		7.440		9.300		12.4		
45	56	PS45 X 56 X >■<	0.680		1.020		1.360		1.700		2.040		3.400		6.800		8.160		10.200		13.6		
48	60	PS48 X 60 X >■<	0.790		1.180		1.580		1.970		2.370		3.950		7.900		9.480		11.800		15.8		

Part Number
Référence Teile Nummer Referencia de pieza
 Tolerance
Tolérance Toleranz Tolerancia
 Weight
Masse Gewicht Peso
 Ring
Anneau/Circlips Ring Anillo
 Groove
Gorge Nut Ranura

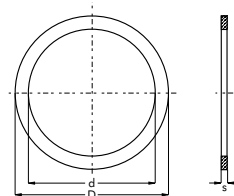

Ø		DIN988 PS	>■< / Ø									
d	D		0.1 -0.03	0.15 -0.04	0.2 -0.04	0.25 -0.04	0.3 -0.05	0.5 -0.05	1.0 -0.05	1.2 -0.07	1.5 -0.07	2.0 -0.07
50	62	PS50 X 62 X >■<	0.83	1.24	1.66	2.07	2.49	4.15	8.30	9.96	12.40	16.60
50	63	PS50 X 63 X >■<	0.91	1.36	1.82	2.27	2.73	4.55	9.10	10.90	13.60	18.20
52	65	PS52 X 65 X >■<	0.94	1.41	1.88	2.35	2.82	4.70	9.40	11.30	14.10	18.80
55	68	PS55 X 68 X >■<	0.98	1.47	1.96	2.45	2.93	4.90	9.80	11.70	14.70	19.60
56	70	PS56 X 70 X >■<	1.09	1.64	2.18	2.73	3.27	5.45	10.90	13.10	16.40	21.80
56	72	PS56 X 72 X >■<	1.27	1.90	2.54	3.17	3.80	6.35	12.70	15.20	19.00	25.40
60	75	PS60 X 75 X >■<	1.25	1.87	2.50	3.12	3.75	6.25	12.50	15.00	18.70	25.00
63	80	PS63 X 80 X >■<	1.50	2.25	3.00	3.75	4.50	7.50	15.00	18.00	22.50	30.00
65	85	PS65 X 85 X >■<	1.85	2.77	3.70	4.62	5.55	9.25	18.50	22.20	27.70	37.00
70	90	PS70 X 90 X >■<	1.97	2.95	3.94	4.92	5.90	9.85	19.70	23.60	29.50	39.40
75	95	PS75 X 95 X >■<	2.09	3.13	4.18	5.22	6.28	10.50	20.90	25.10	31.40	41.80
80	100	PS80 X 100 X >■<	2.22	3.33	4.44	5.55	6.65	11.10	22.20	26.60	33.30	44.40
85	105	PS85 X 105 X >■<	2.34	3.51	4.68	5.85	7.05	11.70	23.40	28.10	35.10	46.80
90	110	PS90 X 110 X >■<	2.47	3.70	4.94	6.17	7.40	12.40	24.70	29.60	37.10	49.40
95	115	PS95 X 115 X >■<	2.59	3.88	5.18	6.47	7.77	13.00	25.90	31.10	38.90	51.80
100	120	PS100 X 120 X >■<	2.72	4.08	5.44	6.80	8.15	13.60	27.20	32.60	40.80	54.40
100	125	PS100 X 125 X >■<	3.47	5.20	6.94	8.67	10.40	17.30	34.70			
105	130	PS105 X 130 X >■<	3.62	5.43	7.22	9.05	10.80	18.10	36.20			
110	140	PS110 X 140 X >■<	4.62	6.93	9.22	11.50	13.90	23.10	46.20			
120	150	PS120 X 150 X >■<	5.00	7.50	10.00	12.50	15.00	25.00	50.00			
130	160	PS130 X 160 X >■<	5.36	8.04	10.70	13.40	16.10	26.80	53.60			
140	170	PS140 X 170 X >■<	5.73	8.60	11.50	14.30	17.20	28.50	57.30			
150	180	PS150 X 180 X >■<	6.10	9.15	12.20	15.20	18.30	30.50	61.00			
160	190	PS160 X 190 X >■<	6.47	9.70	12.90	16.20	19.40	32.30	64.70			
170	200	PS170 X 200 X >■<	6.85	10.30	13.70	17.10	20.60	34.30	68.50			

Part Number
Référence Teile Nummer Referencia de pieza

Tolerance
Tolérance Toleranz Tolerancia

Weight
Masse Gewicht Peso

Ring
Anneau/Circlips Ring Anillo

Groove
Gorge Nut Ranura

