

d ₂	DIN6799 D1500 RA	d ₁		U							H			D A T A						
		from	to	s	Δ	d ₄ max.	α	Δ	C ₂	⚖ (kg/1000)	d ₂	Δ	m min.	n	FN (kN)	d ₁	FR (kN)	g	FRg (kN)	n _{det.} x1000 (rpm)
1.2	RA1.2	1.4	2.0	0.30	±0.02	2.90	1.01	±0.04	3.0	0.009	1.2	-0.060	0.34	0.6	0.04	1.5	0.12	0.4	0.06	47
1.5	RA1.5	2.0	2.5	0.40		3.90	1.28		4.0	0.021	1.5		0.44	0.8	0.07	2.0	0.22	0.6	0.11	42
1.9	RA1.9	2.5	3.0	0.50		4.40	1.61		4.5	0.040	1.9		0.54	1.0	0.10	2.5	0.35	0.7	0.17	40
2.3	RA2.3	3.0	4.0	0.60		5.90	1.94		6.0	0.069	2.3		0.64	1.0	0.15	3.0	0.50	0.9	0.24	38
3.2	RA3.2	4.0	5.0	0.60		6.90	2.70		7.0	0.088	3.2		0.64	1.0	0.22	4.0	0.65	0.9	0.32	35
4.0	RA4.0	5.0	7.0	0.70	±0.03	8.85	3.34	±0.048	9.0	0.158	4.0	-0.075	0.74	1.2	0.25	5.0	0.95	1.0	0.47	32
5.0	RA5.0	6.0	8.0	0.70		10.85	4.11		11.0	0.236	5.0		0.74	1.2	0.90	7.0	1.15	1.0	0.60	28
6.0	RA6.0	7.0	9.0	0.70		11.80	5.26		12.0	0.255	6.0		0.74	1.2	1.10	8.0	1.35	1.1	0.70	25
7.0	RA7.0	8.0	11.0	0.90		13.80	5.84		14.0	0.474	7.0		0.94	1.5	1.25	9.0	1.80	1.3	1.00	22
8.0	RA8.0	9.0	12.0	1.00		15.75	6.52		16.0	0.660	8.0		1.05	1.8	1.42	10.0	2.50	1.5	1.25	20
9.0	RA9.0	10.0	14.0	1.10	±0.03	18.20	7.63	±0.070	18.5	1.000	9.0	-0.090	1.15	2.0	1.60	11.0	3.00	1.6	1.50	17
10.0	RA10.0	11.0	15.0	1.20		19.70	8.32		20.0	1.120	10.0		1.25	2.0	1.70	12.0	3.50	1.8	1.75	15
12.0	RA12.0	13.0	18.0	1.30		22.70	10.45		23.0	1.770	12.0		1.35	2.5	3.10	15.0	4.70	1.9	2.30	13
15.0	RA15.0	16.0	24.0	1.50		28.70	12.61		29.0	3.370	15.0		1.55	3.0	7.00	20.0	7.80	2.2	3.30	11
19.0	RA19.0	20.0	31.0	1.75		36.50	15.92		37.0	6.420	19.0		1.80	3.5	10.00	25.0	11.00	2.5	3.60	8
24.0	RA24.0	25.0	38.0	2.00	43.50	21.88	44.0	8.550	24.0	2.05	4.0	13.00	30.0	15.00	3.0	4.00	6			

Part Number
Référence Teile Nummer Referencia de pieza

Tolerance
Tolérance Toleranz Tolerancia

Weight
Masse Gewicht Peso

Ring
Anneau/Circlips Ring Anillo

Groove
Gorge Nut Ranura

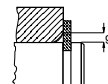
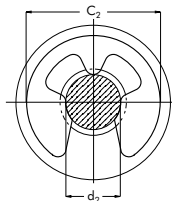
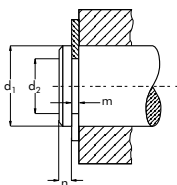
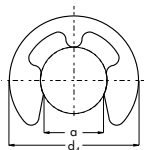

DIN 6799/D1500/RA



CIRTEQ