

**Circlips pour roulements à rouleaux Sicherungsringe für Rollenlager Anillos para cojinetes de rodillos SNAP RINGS FOR ROLLER BEARINGS**

d <sub>1</sub>	DIN5417 M3200 SP	○									⌋										
		s	Δ	b	Δ	d <sub>3</sub>	Δ	e ≈	r min.	(kg/1000)	d <sub>2</sub>	Δ	m	Δ	C <sub>2</sub>	FN (kN)	FR (kN)	g	FRg (kN)	K (kN/mm)	Nobl. x1000 (rpm)
30	SP30	1.12		3.25		27.4		3	0.4	2.8	28.17		1.35		34.7	13.7	16.6	2.0	2.91	35.1	16
32	SP32	1.12		3.25		29.4		3	0.4	3.0	30.15		1.35		36.7	14.6	14.6	2.0	2.57	30.0	13
35	SP35	1.12		3.25		32.4	+0.4	3	0.4	3.2	33.17		1.35		39.7	16.0	13.4	2.0	2.42	28.0	11
37	SP37	1.12		3.25		34.0		3	0.4	3.4	34.77		1.35		41.3	20.7	13.6	2.0	2.45	26.6	10
40	SP40	1.12		3.25		37.3		3	0.4	3.6	38.10		1.35		44.6	19.3	13.5	2.0	2.50	24.2	8
42	SP42	1.12		3.25		38.9		3	0.4	3.8	39.75		1.35		46.3	23.5	12.9	2.0	2.39	23.4	7
44	SP44	1.12		3.25		40.9		3	0.4	4.0	41.75		1.35		48.3	24.6	12.4	2.0	2.29	22.6	7
47	SP47	1.12		4.04		43.7	+0.5	4	0.4	5.3	44.60	-0.25	1.35		52.7	28.8	12.1	2.0	2.29	22.4	7
50	SP50	1.12		4.04		46.6		4	0.4	5.8	47.60		1.35		55.7	30.6	13.3	2.0	2.60	24.3	6
52	SP52	1.12		4.04		48.8		4	0.4	5.9	49.73		1.35		57.9	31.6	12.8	2.5	2.01	23.4	6
55	SP55	1.12		4.04		51.7		4	0.4	6.2	52.60		1.35		60.7	33.8	11.8	2.5	1.90	22.0	5
56	SP56	1.12		4.04		52.4		4	0.4	6.5	53.60		1.35		61.7	34.5	12.1	2.5	1.95	21.6	5
58	SP58	1.12		4.04		54.4		4	0.4	6.7	55.60		1.35		63.7	35.6	11.5	2.5	1.89	21.0	5
62	SP62	1.70		4.04		58.2		4	0.6	10.5	59.61		1.90		67.7	38.1	37.6	2.5	6.18	68.6	5
65	SP65	1.70		4.04		61.2		4	0.6	11.0	62.60		1.90		70.7	40.0	34.9	2.5	5.89	65.3	4
68	SP68	1.70	-0.1	4.85	-0.15	63.4		5	0.6	12.6	64.82		1.90		74.6	55.5	40.9	2.5	7.06	75.0	4
72	SP72	1.70		4.85		67.4	+0.8	5	0.6	14.7	68.81		1.90	+0.3	78.6	59.0	38.9	2.5	6.17	71.3	4
75	SP75	1.70		4.85		70.4		5	0.6	15.3	71.83		1.90		81.6	61.5	36.6	2.5	6.46	68.6	3
80	SP80	1.70		4.85		75.4		5	0.6	16.3	76.81		1.90		86.6	65.7	34.8	3.0	5.25	64.0	3
85	SP85	1.70		4.85		80.4		5	0.6	17.5	81.81		1.90		91.6	70.0	33.5	3.0	5.16	60.5	3
90	SP90	2.46		4.85		85.4		5	0.7	26.6	86.79		2.70		96.5	74.0	93.9	3.0	14.80	174.0	2
95	SP95	2.46		4.85		90.4		5	0.7	28.2	91.82		2.70		101.6	76.3	86.8	3.5	12.00	164.0	2
100	SP100	2.46		4.85		95.2		5	0.7	29.2	96.80		2.70		106.5	82.5	80.8	3.5	11.40	155.0	2
110	SP110	2.46		4.85		105.2		5	0.7	32.8	106.81		2.70		116.6	90.7	71.2	3.5	10.40	142.0	1
115	SP115	2.46		4.85		110.2	+1.0	5	0.7	34.4	111.81	-0.50	2.70		121.6	97.7	66.6	3.5	10.00	136.0	1
120	SP120	2.82		7.21		113.6		7	0.7	60.6	115.21		3.10		129.7	143.0	140.0	3.5	21.30	291.0	2
125	SP125	2.82		7.21		118.6		7	0.7	63.0	120.22		3.10		134.7	155.0	132.0	4.0	17.90	279.0	2
130	SP130	2.82		7.21		123.6		7	0.7	65.6	125.22		3.10		139.7	166.0	124.7	4.0	17.30	269.0	1
140	SP140	2.82		7.21		133.0		7	0.7	70.6	135.23		3.10		149.7	180.0	111.6	4.0	16.00	249.0	1
145	SP145	2.82		7.21		138.0		7	0.7	73.0	140.23		3.10		154.7	186.0	106.4	4.0	15.50	242.0	1
150	SP150	2.82		7.21		142.9	+1.6	7	0.7	77.2	145.24		3.10		159.7	193.0	101.5	4.0	15.00	234.0	1
160	SP160	2.82		7.21		152.9		7	0.7	81.0	155.22		3.10		169.7	206.0	92.0	4.0	14.10	220.0	1
170	SP170	3.10		9.60		161.3		10	0.7	122.0	163.65		3.50		182.9	283.0	148.0	5.0	18.70	363.0	1
180	SP180	3.10		9.60		171.2		10	0.7	128.0	173.66		3.50		192.9	292.0	135.0	5.0	17.70	344.0	1
190	SP190	3.10		9.60		181.0	+1.8	10	0.7	139.0	183.64		3.50		202.9	311.0	124.0	5.0	16.70	324.0	1

**Part Number**  
Référence Teile Nummer Referencia de pieza
 **Tolerance**  
Tolérance Toleranz Tolerancia
 **Weight**  
Masse Gewicht Peso
 **Ring**  
Anneau/Circlips Ring Anillo
 **Groove**  
Gorge Nut Ranura

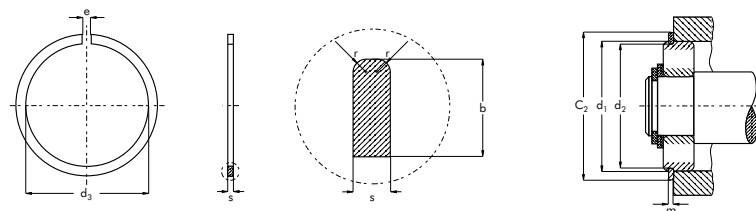

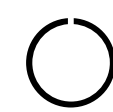

DIN 5417/M3200/SP



d <sub>1</sub>	DIN5417 M3200 SP	○									H				D A T A						
		s	Δ	b	Δ	d <sub>3</sub>	Δ	e ≈	r min.	$\frac{\Delta}{(kg/1000)}$	d <sub>2</sub>	Δ	m	Δ	C <sub>2</sub>	FN (kN)	FR (kN)	g	FRg (kN)	K (kN/mm)	nabl. x1000 (rpm)
200	SP200	3.10	-0.15	9.60	+1.8	191.0	10	0.7	148.0	193.65	+0.3	3.50	-0.50	212.9	336.0	116.0	5.0	16.00	311.0	1.0	
210	SP210	3.10		9.60		200.9		1.2	156.0	203.60		222.8		356.0	106.0	6.0	12.70	295.0	1.0		
215	SP215	3.10		9.60		205.9		1.2	160.0	208.60		227.8		376.0	103.0	6.0	12.40	288.0	1.0		
225	SP225	3.50		10.00		214.3		1.2	196.0	217.00		237.0		462.0	144.0	6.0	17.90	416.0	1.0		
230	SP230	3.50		10.00		219.2		1.2	200.0	222.00		242.0		473.0	139.1	6.0	17.40	406.0	1.0		
240	SP240	3.50	-0.1	10.00	+2.5	229.2	10	1.2	209.0	232.00	+0.4	4.50	-0.50	252.0	495.0	130.0	6.0	16.80	390.0	0.5	
250	SP250	3.50		10.00		239.2		1.2	220.0	242.00		262.0		514.0	122.0	6.0	16.10	374.0	0.5		
260	SP260	3.50		10.00		247.5		1.2	230.0	252.00		272.0		536.0	114.0	6.0	15.50	360.0	0.5		
270	SP270	3.50		10.00		257.5		1.2	240.0	262.00		282.0		556.0	107.0	6.0	14.90	347.0	0.5		
280	SP280	3.50		10.00		267.5		1.2	250.0	272.00		292.0		578.0	101.0	6.0	14.40	335.0	0.5		
290	SP290	3.50	-0.2	10.00	+3.0	277.5	10	1.2	260.0	282.00	+0.5	4.50	-0.50	302.0	598.0	95.4	6.0	13.90	323.0	0.4	
300	SP300	4.50		12.00		284.5		1.5	400.0	290.00		314.0		694.0	230.0	7.0	34.20	795.0	0.6		
310	SP310	4.50		12.00		294.0		1.5	412.0	300.00		324.0		800.0	218.0	7.0	28.40	770.0	0.5		
320	SP320	4.50		12.00		304.0		1.5	420.0	310.00		334.0		824.0	207.0	7.0	27.60	747.0	0.5		
340	SP340	4.50		12.00		324.0		1.5	446.0	330.00		354.0		875.0	187.0	7.0	26.00	702.0	0.4		
360	SP360	4.50	-0.2	12.00	+3.0	343.0	10	1.5	475.0	350.00	+0.5	5.50	-0.50	374.0	930.0	169.0	7.0	24.50	664.0	0.4	
370	SP370	4.50		12.00		353.0		1.5	485.0	360.00		384.0		955.0	162.0	7.0	23.80	646.0	0.4		
380	SP380	4.50		12.00		363.0		1.5	500.0	370.00		394.0		995.0	154.0	7.0	23.20	629.0	0.4		
400	SP400	4.50		12.00		383.0		1.5	525.0	390.00		414.0		1040.0	144.0	7.0	22.10	598.0	0.3		

**Part Number**  
Référence Teile Nummer Referencia de pieza

**Tolerance**  
Tolérance Toleranz Tolerancia

**Weight**  
Masse Gewicht Peso

**Ring**  
Anneau/Circlips Ring Anillo

**Groove**  
Gorge Nut Ranura

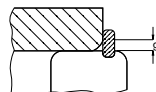
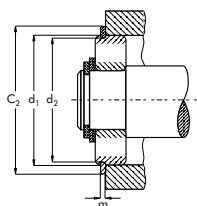
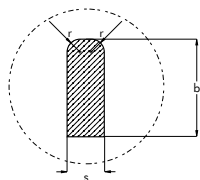
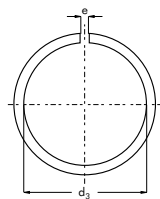

DIN 5417/M3200/SP



**CIRTEQ**